

14th MHD Control Workshop at PPPL, Princeton, Nov.2009
Announcement of next Workshop

15th Workshop on Active Control of MHD Stability combined with the **US-Japan Workshop on MHD Control**

A Workshop at the Pyle Center
University of Wisconsin, Madison

November 15-17, 2010
Following APS-DPP in Chicago

Madison conveniently located 3 hour from Chicago. “Balmy” weather, “fresh” air.

3 hour drive or bus ride (<http://www.coachusa.com/vangalder/>)
40 min flight

Badgers' game with Indiana on Saturday

Conference: **Mon-Wed**

but **Sun-Tue** still possible (negotiating with Doubletree Hotel)



Weather example: now, [Madison, WI](#)
and next few days:



46° F

Current: Partly Cloudy
Wind: SE at 5 mph
Humidity: 76%

Wed



33° | 57°

Thu



40° | 56°

Fri



49° | 58°

Sat



36° | 54°

Workshop will be held at Pyle Center

- Same location as 2005 Workshop
- Conference rooms, from 8 to 300 seats
- Expect usual ~50 attendants
 - + ~10 more from Japan
 - +5-10 UW students and staff (occasional)
- University-owned → low fee
- <http://conferencing.uwex.edu/>

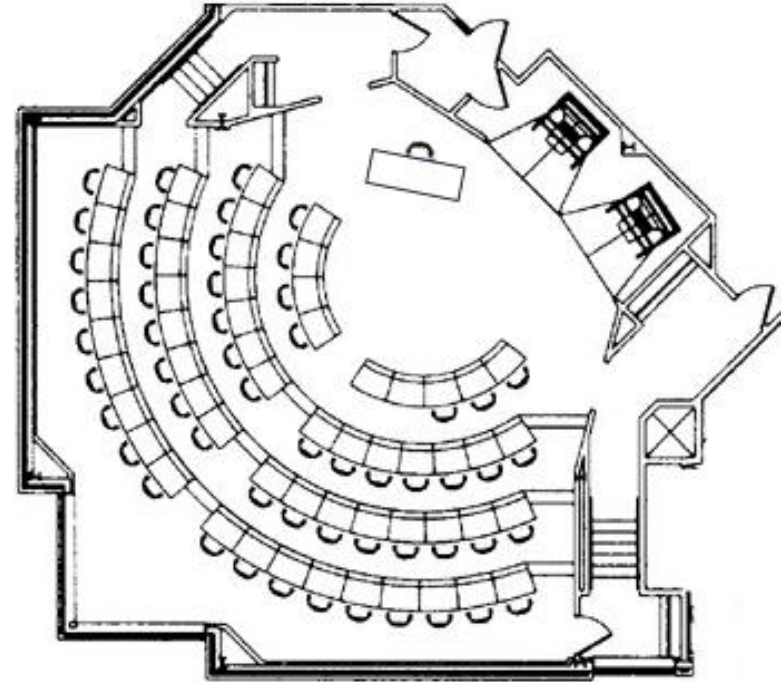

Everything at a walking distance

Eng. Phys., Pegasus

Physics Dept, MST

Pyle Center

2mi

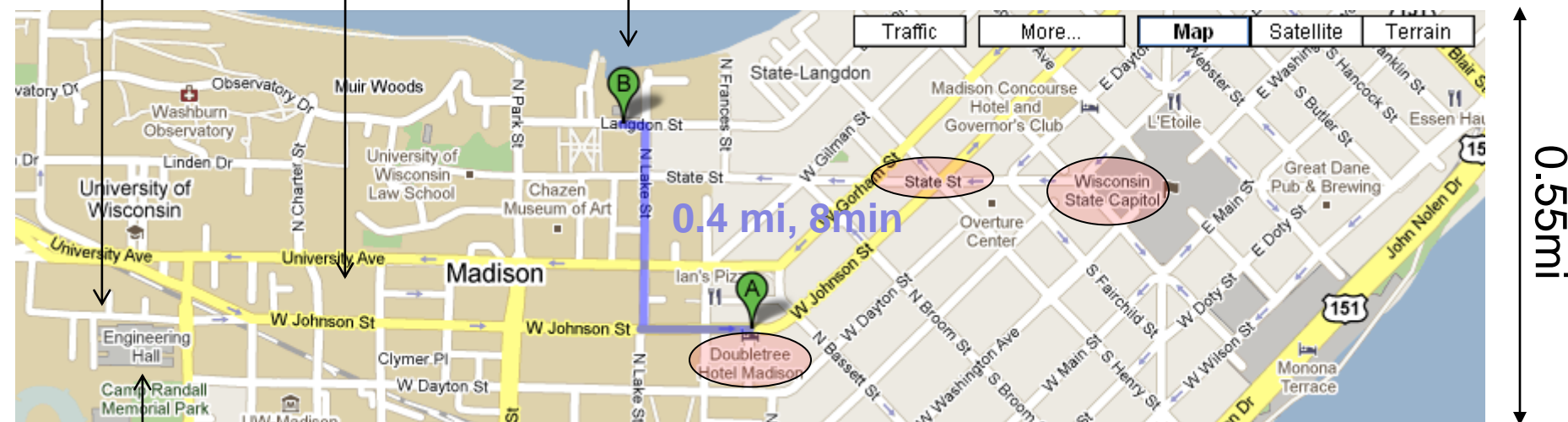

Electrical Eng., HSX

Proposed Themes

Integrated stability control: issues, experience, synergies

..and “anti-synergies”?

(J. Sarff, F. Volpe, R. La Haye)

Back from the Brink - Recovery of Potentially Deleterious Events

[Disruptions]

(R. Buttery, R. Paccagnella, F. Volpe)

Commonalities in MHD Control in Tokamak s and RFPs

(T. Bolzonella)

3-D Magnetic Field Effects

(J. Navratil)

Better understanding of non linear MHD for MHD control

[saturated MHD, steady state operation]

(M. Okabayashi)

Possible Multi-mode sub-themes

RWM ($n=1$, f/back) and ELM ($n=3$, d.c.)

RWM and EFC

Multi-mode RWM ctrl (NSTX, $n=5,6,7$ RFX-mod)

RWM control and mode unlocking

NTM triggers

2/1 and 3/2 NTM (and sawteeth i.e. $q=1$?)

Program and Local Organizing Committee

Richard Buttery	(General Atomics)
Robert La Haye	(General Atomics)
Piero Martin	(RFX-mod)
Gerald Navratil	(Columbia University)
Michio Okabayashi	(PPPL)
T. Ozeki	(JAEA Naka)
John Sarff	(Univ. Wisconsin)
François Waelbroeck	(Univ. Texas)
K. Yamazaki	(Nagoya University)

Local Organizing Committee

John Sarff	(co-chair)
Francesco Volpe	(co-chair)
Sheryl Jones	(administrative)